

PERMIT

CITY OF NAPOLEON - BUILDING DEPARTMENT

255 West Riverview Avenue, Napoleon, Ohio 43545 - 419-592-4010

Permit No. 171-78 Issued 9-28-78
date

Job Location 35 Bordeaux Drive
address

Lot 29 Riviera Heights
sub-div or legal discript

Issued By R.P. Johnson
building official

Owner Carl Damon
name tel.

Address 35 Bordeaux Drive Nap, Ohio

Agent Beck's Const. 592-8307
builder-eng.-etc. tel.

Address Rt 11-622 Rd M Rt.3 Nap. Ohio

Description of Use ADD' N. to House

Residential one
no. dwelling units

Commercial _____ Industrial _____

New _____ Add'n. XX Alter _____ Remodel _____

Mixed Occupancy _____

Change of Occupancy _____

Estimated Cost \$ 8,600.00

FEES	BASE	PLUS	TOTAL
<input checked="" type="checkbox"/> BUILDING	\$22.50	0	\$22.50
<input checked="" type="checkbox"/> ELECTRICAL	5.00	\$3.00	8.00
<input type="checkbox"/> PLUMBING			
<input checked="" type="checkbox"/> MECHANICAL	0	0	0
<input type="checkbox"/> DEMOLITION			
<input checked="" type="checkbox"/> ZONING	0	0	0
<input type="checkbox"/> SIGN			
WATER TAP			
SEWER TAP			
TEMP. ELECT.			
ADDITIONAL PLAN REVIEW	Struct. _____ hrs	Elect. _____ hrs	
TOTAL FEES.....			\$30.50
LESS MIN. FEES PAID _____			0
BALANCE DUE.....			\$30.50

ZONING INFORMATION

district "A"	lot dimensions 80' x 121.5'	area 9,720sq'	front yd n/a	side yds 15' & 450' OK	rear yd 54.5' OK
max hgt OK	no pkg spaces no additional	no ldg spaces n/a	max cover 35%OK	petition or appeal req'd -----	date appr ----

WORK INFORMATION:

Size: Length 20' Width 16' Stories 1 Ground Floor Area 320sq'

Height _____ Building Volume (for demo. permit) _____ cu. ft.

Electrical: 3 new circuits
brief description

Plumbing: _____
brief description

Mechanical: Baseboard heat.
brief description

Sign: _____ Dimensions _____ Sign Area _____

Additional Information: CALL FOR INSPECTIONS MARKED ON ATTACHED SHEET:

PAID
SEP 29 1978

CITY OF NAPOLEON

Date Sept 29, 1978 Applicant Signature Frances M. Beck Sec. & Treas.
owner-agent

INSPECTION RECORD

	UNDERGROUND			ROUGH-IN						FINAL		
	Type	Date	By	Type	Date	By	Type	Date	By	Type	Date	By
PLUMBING	Building Drains			Drainage, Waste & Vent Piping			Indirect Waste			Drainage, Waste & Vent Piping		
	Water Piping									Backflow Prevention		
	Building Sewer			Water Piping			Condensate Lines			Water Heater		
	Sewer Connection									FINAL APPROVAL		
MECHANICAL	Refrigerant Piping			Refrigerant Piping			Chimney(s)			Grease Exhaust System		
				Duct Furnace(s)			Fire Dampers			Air Cond. Unit(s)		
	Ducts/Plenums			Ducts/Plenums			<input type="checkbox"/> Radiant Htr(s) <input type="checkbox"/> Unit Htr(s)			Refrigeration Equipment		
				Duct Insulation			Pool Heater			Furnace(s)		
				Combustion Products Vents			Ventilation <input type="checkbox"/> Supply <input type="checkbox"/> Exhst.			FINAL APPROVAL		
ELECTRICAL	Conduits & or Cable			Conduits/Cable			<input type="checkbox"/> Range <input type="checkbox"/> Dryer			Temp Service Temp Lighting		
	Grounding & or Bonding			Rough Wiring		10-19-78 NH	<input type="checkbox"/> Generator(s) <input type="checkbox"/> Motors			Fixtures Lampholders		
	Floor Ducts Raceways			Service Panel Switchboard			<input type="checkbox"/> Water Htr <input type="checkbox"/> Welder			Signs		
	Service Conduit			Busways Ducts			<input type="checkbox"/> Heaters <input type="checkbox"/> Heat Cable			Electric Mtr. Clearance		
	Temporary Power Pole			Subpanels			<input type="checkbox"/> Duct Htr(s) <input type="checkbox"/> Furnace(s)			FINAL APPROVAL	11-9-78 NH	
BUILDING	Location, Set-backs, Esmt(s)			Exterior Wall Construction			Roof Covering Roof Drainage			Smoke Detector		
	Excavation						Exterior Lath			Demolition (sewer cap)		
	Footings & Reinforcing						<input type="checkbox"/> Interior Lath <input type="checkbox"/> Wallboard					
	Floor Slab			Interior Wall Construction			Fire Wall(s)			Building or Structure		
	Foundation Walls			Columns & Supports			Fireplace Chimney					
	Sub-soil Drain			Crawl Space <input type="checkbox"/> Vent <input type="checkbox"/> Access			Attic <input type="checkbox"/> Vent <input type="checkbox"/> Access					
	Piles			Floor System(s)						FINAL APPROVAL BLDG. DEPT.		
			Roof System			Special Insp Reports Rec'd			Certificate of Occupancy Issued			
ADDITIONAL	INSPECTIONS, CORRECTIONS, ETC.						INSPECTIONS, CORRECTIONS, ETC.					
	PAID											
	SEP 29 1978											
	CITY OF WABOFEON											

The undersigned hereby makes application for the installation, replacement or alteration of a heating system as follows as herein specified, agreeing to do all such work in accordance with the City of Knoxville's adopted Mechanical Code and all applicable building regulations.

Owner's Name Carl Damon Address 33 Bordeaux
Contractor's Name Beck's Const Phone No. RR3 11-622 Tel. 5928307

BUILDING INFORMATION

Single Family Double Multiple New Construction
Addition Remodel Alteration No. of Stories 1

CHARACTERISTICS OF WORK

Heating System - Warm Air Hot Water Gas Electric

Unit Heating Other

Type - Gravity Radiant

No. of Thermostats 1

Hot Water - Flow Pipe Return Pipe Series Loop

Electric Heat - No. of Circuits 1 Other

Total Heat Load of Area to be heated 320 Btu.

Rated Capacity of Furnace/Boiler Btu.

No. of Furnaces No. of Hot Air Fans

No. of Hot Water Radiators Type of Fuel

Heating Units Located: Under Floor Floor Level Suspended

Roof or Exposed to Weather Other

APPLICATION FOR PERMIT SHALL BE ACCOMPANIED BY TWO COMPLETE SETS OF PLANS INCLUDING: LOCATION OF UNITS, RADIATORS AND STEP AND LOCATION OF FREEDOM DUCTS AND RETURN AIR DUCTS. ALL PLANS SHALL BE DRAWN TO SCALE.

ESTIMATED COST OF WORKED UP WORK

DATE Sept 25, 78 APPLICANT'S SIGNATURE Robert S Beck
OWNER-CONTRACTOR-AGENT

CITY OF NAPOLEON
BUILDING INSPECTION DEPARTMENT
APPLICATION FOR CONSTRUCTION PERMIT
(PLEASE PRINT OR TYPE)

171-78

The undersigned hereby makes application for the construction, installation, replacement or alteration as herein specified, agreeing to do all such work in strict accordance with the City of Napoleon's Building Code for 1, 2 and 3 Family Buildings.

Owner's Name Carl Damon Address 35 Bordeaux
Builder's Name Beck's Const Address RR3 11-622 Tel. 592-8307

LOT INFORMATION: (Not required for roofing or siding job.)

Location of Project Riveria Hts. Lot# 35 Bord.
Subdivision Riveria Hts Lot Area _____ Sq. Ft.
Yard Setback: Front _____ Rear _____ Left Side _____
Right Side _____ Zoning District _____

BUILDING INFORMATION:

Single _____ Double _____ Multiple _____ New Construction _____
Addition Remodel Attached Garage _____
Detached Garage _____ Accessory Building _____ Replacement _____
Brief Description of Work: 16X20 FM. RM.

Size: Length 20' Width 16' No. of Stories _____
Floor Area: 1st Floor 320 Sq. Ft. 2nd Floor _____ Sq. Ft.
3rd Floor _____ Sq. Ft. Basement _____ Sq. Ft.
Unfinished Attic _____ Garage _____
Foundation: Piers 30x30 Full Basement _____ Part Basement _____
Concrete 8" Thickness Block 8x8"16" Size _____
Walls: Frame Block _____ Brick _____ Other Alu Siding
Specific Type of Exterior Siding Alu. Siding

APPLICATION FOR PERMIT SHALL BE ACCOMPANIED BY TWO COMPLETE SETS OF PLANS INCLUDING: ELEVATIONS, FLOOR PLANS, CROSS SECTIONS AND PLOT PLAN. IF ADDITIONS OR REMODELING, SHOW ALL EXISTING STRUCTURE AND THEIR SIZE AND LOCATION. ALL PLANS SHALL BE DRAWN TO SCALE.

ESTIMATED COST OF COMPLETED PROJECT: \$8,600

DATE Sept 25 78 APPLICANT'S SIGNATURE

Robert J Beck
OWNER-BUILDER-AGENT

PLOT PLAN FOR:
BECK CONST. CO.

LOT 29
RIVIERA HEIGHTS SUBDIVISION
NAPOLEON, OH IO

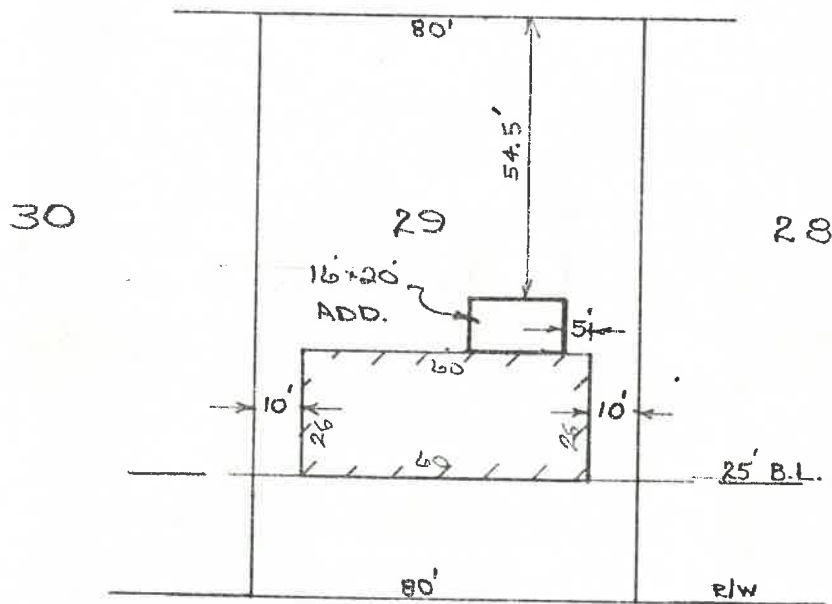

¢ BORDEAUX 60' R/W

CITY OF NAPOLEON
BUILDING DEPT.

Plan Approval

By ADJ. Date 9-28-78

DWG: R. WENTLING



Bordeaux Dr.

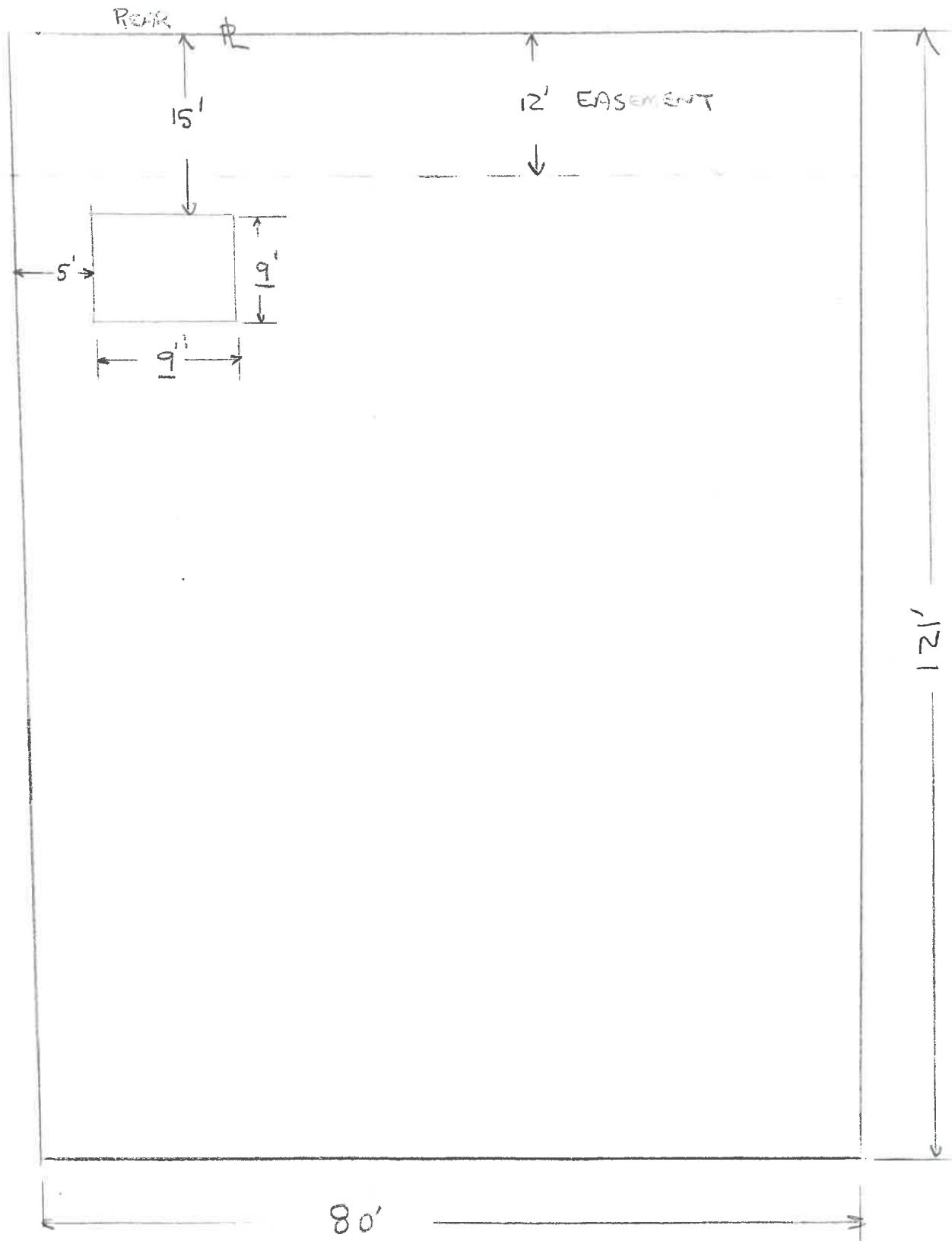

80'
BOARDERLY DRIVE

NOT TO SCALE

No. ...160.....

CERTIFICATE OF OCCUPANCY
THE CITY OF NAPOLEON

ENGINEERING DEPARTMENT
DIVISION OF INSPECTION

This is to certify that the Building or Land as herein described complies with all the building and health laws and ordinances and with the provisions of the Zoning Ordinance.

Location of Occupancy 35 Bordeaux Drive Occupancy Single Family Dwelling
Owner of Property Carl Damon Address Napoleon, Ohio Family Room Addition
Issued to Beck's Construction Co. Address 11-622 Rd. M, Rt. 3 35 Bordeaux Dr.
Zoning "A" Residence District Bldg. Permit No. 171-78 Napoleon, Ohio

Substantial qualifications of occupancy

This certificate is issued by the City Building Inspector, as provided by law, and is to certify that construction is completed substantially in conformity with the approved plans and permission is hereby granted to occupy such building in compliance with such legal use and occupancy as authorized under the provisions of the ordinances of the City of Napoleon.

Issued this 1st day of December 1978.....

This is a valuable record for owner or lessee and should be so preserved.

[Signature]
City Building Inspector

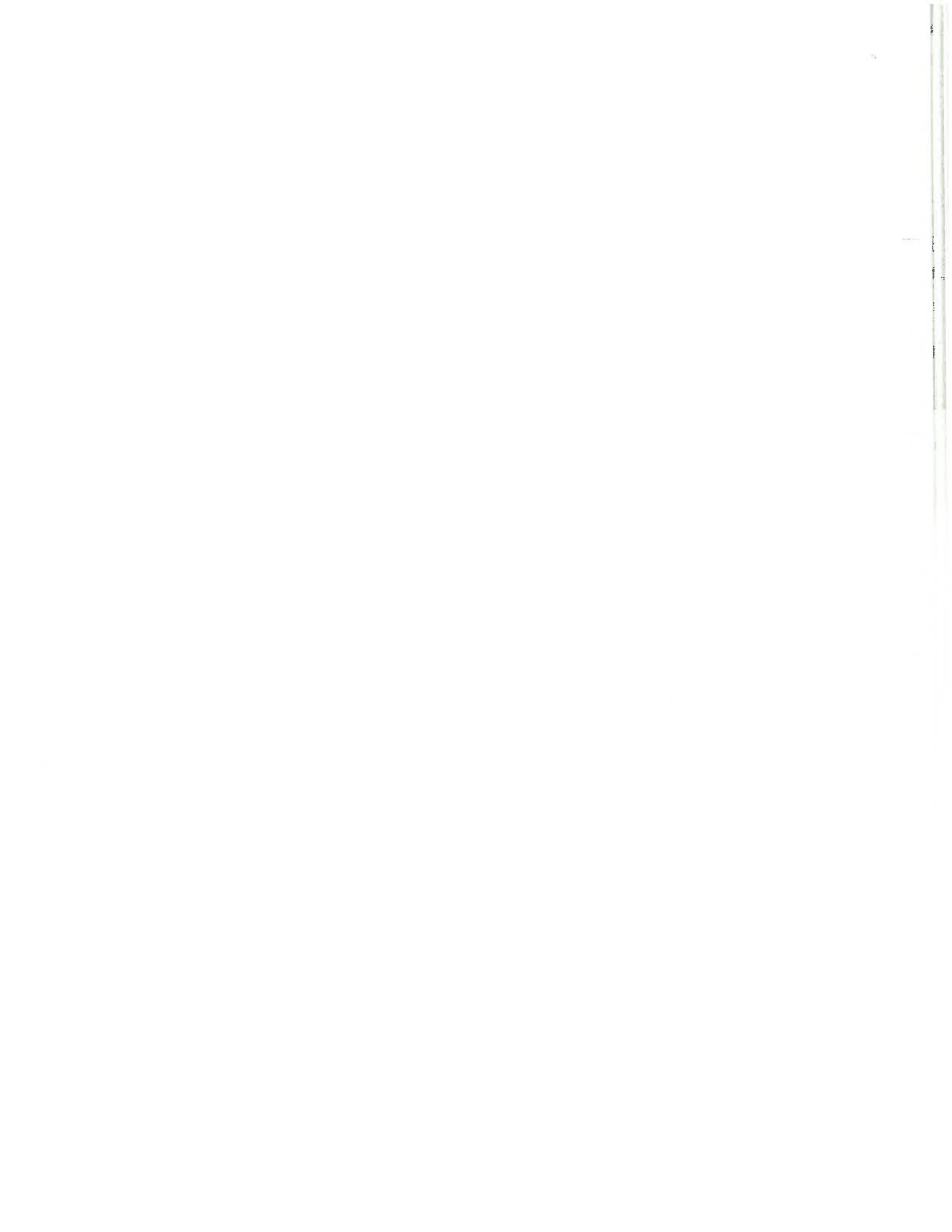

No. 047
CERTIFICATE OF OCCUPANCY
THE CITY OF NAPOLEON

ENGINEERING DEPARTMENT
DIVISION OF INSPECTION

This is to certify that the Building or Land as herein described complies with all the building and health laws and ordinances and with the provisions of the Zoning Ordinance.
Location of Occupancy 35 Bordeaux Drive (Lot #29) Single Family-Residence (New Dwelling)

Owner of Property Robert L. Beck Address R.R. 3, Napoleon

Issued to Robert L. Beck Address R.R. 3, Napoleon

Zoning "A" Residential Bidg. Permit No. 399-75

Substantial qualifications of occupancy The water ~~sanitary~~ plumbing system shall be protected in an approved manner against backflow. Section BB-51-38 of Plumbing Code.

This certificate is issued by the City Building Inspector, as provided by law, and is to certify that construction is completed substantially in conformity with the approved plans and permission is hereby granted to occupy such building in compliance with such legal use and occupancy as authorized under the provisions of the ordinances of the City of Napoleon.

Issued this 23rd day of February, 1976

This is a valuable record for owner or lessee and should be so preserved.

Signed *[Signature]* City Building Inspector

175 1st 10 circuits
 15.00 35 circuits @ 60 each
 7.00 Appl circuits
23.75 Total

CITY OF NAPOLEON
 ENGINEERING DEPARTMENT
 APPLICATION FOR ELECTRICAL PERMIT
 (PLEASE PRINT OR TYPE)

The undersigned hereby makes application for the installation, replacement, or alteration of electrical equipment as herein specified, agreeing to do all such work in strict accordance with the City of Napoleon's adopted Electrical Code for 1, 2 and 3 Family Buildings.

Owner's Name _____ Address _____

Contractor's Name _____ Address _____ Tel. _____

LOT INFORMATION:

Location of Project _____ Zoning District _____

BUILDING INFORMATION:

Single Family _____ Double Family _____ Multiple Family _____

New Construction _____ Existing _____ Addition _____

Replacement _____ Remodel _____ Service Change _____

Size: Total Square Foot Per Floor _____ No. of Stories _____

DESCRIPTION OF WORK

Size of Service 200 AMP. Service Change Only No (Yes or No)

Total Number of New Circuits 42 Total Number of New Circuits Excluding Appliance Circuits 35

APPLIANCE CIRCUITS: (indicate quantity)

Electric Range 1 Range Hood 1 Clothes Dryer 1 Dishwasher 1

Air Conditioner No Attic Fan Blower No Room Exhaust Fan 1

Disposal 1 Hot Water Heater 1 Electric Oven No

Require Temporary Electric yes (Yes or No)

Note: G.F.I.C. required for all temporary electric with approved ground rod at service.

APPLICATION FOR PERMIT SHALL BE ACCOMPANIED BY TWO COMPLETE SETS OF PLANS INCLUDING: ELECTRICAL LAY-OUT AND RISER DIAGRAM.

ESTIMATED COST OF COMPLETED PROJECT: Robert L Beck

DATE 10/1/75 APPLICANT'S SIGNATURE _____

OWNER-CONTRACTOR-AGENT

42/35



CITY OF NAPOLEON
ENGINEERING DEPARTMENT
APPLICATION FOR CONSTRUCTION PERMIT
(PLEASE PRINT OR TYPE)

The undersigned hereby makes application for the construction, installation, replacement or alteration as herein specified, agreeing to do all such work in strict accordance with the City of Napoleon's Building Code for 1, 2 and 3 Family Buildings.

Owner's Name Robert L Beck Address RR 3 Napoleon O.
Builder's Name Beck's Const. Address RR 3 Nap. Tel. 592 0137

LOT INFORMATION:

Location of Project _____ Lot # 29
Subdivision Riviera Hts. Lot Area _____ Sq. Ft. _____
Yard Set Back: Front _____ Rear _____ Left Side 10'
Right Side 10' Zoning District _____

BUILDING INFORMATION:

Single Double _____ Multiple _____ New Construction

Addition _____ Remodel _____ Attached Garage _____

Detached Garage _____ Accessory Building _____ Replacement _____

Description of Building _____

Specific Occupancy Use One family

Size: Length 60 Width 26 No. of Stories one

Floor Area: 1st Floor 988 Sq. Ft. 2nd Floor _____ Sq. Ft.

3rd Floor _____ Sq. Ft. Basement _____ Sq. Ft.

Unfinished Attic _____ Garage 572 sq ft

Foundation: Piers 36x36 Full Basement _____ Part Basement _____

Concrete 8" Thickness Block 8x8x16 Size _____

Walls: Frame Block _____ Brick _____ Other _____

Specific Type of Exterior Siding gly siding

APPLICATION FOR PERMIT SHALL BE ACCOMPANIED BY TWO COMPLETE SETS OF PLANS INCLUDING: ELEVATIONS, FLOOR PLANS, CROSS SECTIONS AND PLOT PLAN. IF ADDITIONS OR REMODELING, SHOW ALL EXISTING STRUCTURES AND THEIR SIZE AND LOCATION. ALL PLANS SHALL BE DRAWN TO SCALE.

ESTIMATED COST OF COMPLETED PROJECT: \$ 23,000

DATE Sept 30 1975 APPLICANT'S SIGNATURE Robert L Beck
OWNER-BUILDER-AGENT

APPLICATION FOR PERMIT TO TAP SEWER

No. 677

Date 10-1, 1975

Name Robert L. Beck

Address RT #3, Napoleon, Ohio 43545

LOCATION OF CONNECTION

Street and Number 35 Bordeaux Drive

Lot No. 29

Addition Riviera Heights

Date work will start 10-16-75 (All work must be inspected)

Work will be done by Ron Meyers Plumbing + Heating, Inc.

I certify that the sewer will be used only as indicated and no other drainage will be connected.

Applicant _____

Date _____

Address _____

Permit Fee \$60.00

Bldg. permit # 399-75
pd. 10-6-75

R. W. Schweinhagen (J.C.)
Certification by City Clerk

Work inspected by: Thomas Terranova - Building Inspector

Work Completed 10-16-75

Remarks Tested by means of 5 P.S.I. air test which held
For 15 minutes.

Name of Contractor: Ron Meyers Size of Tap 4" Date 10-16-75

Street 35 Bordeaux Drive Size and Kind of Sewer 4" Vitrified

Old No. _____ Location of Sewer IN front of hse.

New No. _____ Depth of Sewer @ tap 9'

Crossover _____ Distance to Curb Stop _____

Remarks Tested and approved by *[Signature]* 10-16-75

